

Document:	Datasheet	Author /Date:	HE / 21.11.2017
Version:	V1.2	Approved /Date:	MI / 21.11.2017
Category:	Hydrotor		

## Service Kit KT-207839 to C & D Series (ex CMD)

PARTS LIST			
ITEM	QTY	PART NUMBER	DESCRIPTION
1	1	BB-100060	BALL BEARING
2	1	GA-100061	O-RING
3	1	GA-100064	O-RING
4	1	HP-203094	SEAL HOLDING PIECE
5	2	KY-4-6	ALLOY WOODRUFF KEY
6	1	PG-1124	PLUG
7	1	RG-100036	RETAINING RING
8	1	RG-1104	RETAINING RING
9	1	RG-1137	SLIPPER SEAL (CMD)

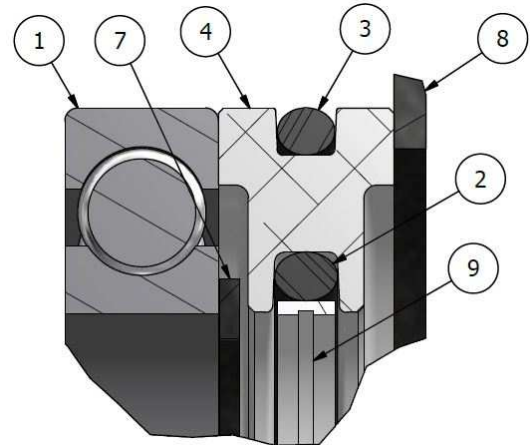

### Assembly Instructions

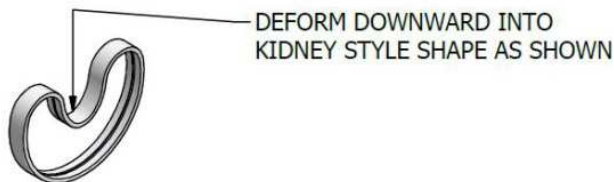

### RG-1137 (INSTALL)

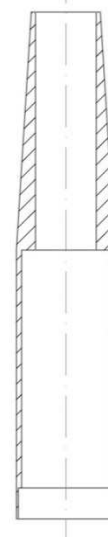

Assembly tool EHS-41-2858

### Assembly Notes

Items 5 and 6 are not used in C Series (ex CMD-2A) Motor assembly.  
Use Assembly tool EHS-41-2858 to avoid damages during mounting.

W:\DOKUMENTATION 2\Geräte\01\_HydraulicStarting\Datasheets\Hydrotors\CMD - C & D Series\KT-207839\Vorlagen\HT Datasheet KT-207839\_EN\_11.2017.docx